

# HERBOLD



## Herbold Single-shaft Shredder The New Generation of the EWS 45 series

The Herbold single-shaft shredder is a further development of the HR shredder series for high throughputs and difficult applications.



Fig.1: EWS 45/120

### Drive system

- no gear box, trouble-free drive via countershaft drive; thus optimum protection against damages caused by foreign bodies
- energy saving due to the high centrifugal mass of the pulley in case of peak loads
- better efficiency compared to gear-box drives
- easy speed changes

### Cutting system

- rotor drum with variable knife configuration in cartridges, easy to change
- adjustable stator knives
- rotor and stator knives made from extra wear-resistant materials
- oversized self-aligning roller bearings in pillow block housings, completely outside and separated from the grinding chamber
- optionally the rotor is available with water cooling



Fig. 2: Rotor with variable knife configuration

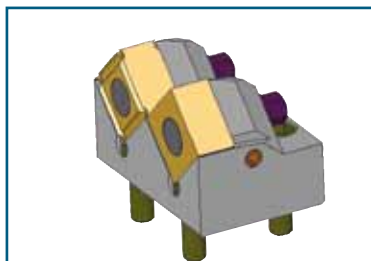

Fig. 3: 2-knife cartridges

### Shredder design

- solid welded steel construction, designed for heavy-duty applications
- grinding chamber exchangeable, in case of wear or serious damage, it is possible to put the shredder into operation again with an exchange housing within an extremely short period of time
- hydraulic ram in heavy-duty design with anti-wear plates
- PLC with programmable ram action
- hydraulically operated drop-down screen cradle, easy screen change
- excellent access for maintenance works, knife change, hydraulic feeding system



Fig. 4: V-belt drive by countershaft drive



Fig. 5: Screen support hydraulically controlled, convenient, fast screen change

## Technical data of the Herbold shredder of the EWS series

### EWS 45/120

Weight	approx. 7000 kg (15,400 lbs)
Stroke length	standard 1300 mm (51.2") optional 2500 mm (98.4")
Rotor diameter	450 mm (18")
Rotor knives	variable configuration 20 - 60
Rotor knives	useable on all 4 sides
Stator knife rows	2 (2 x 2 knife supports)
Stator knives	useable on 2 sides
Screen insert	according to the application
Drive	45 - 90 kW (60 - 125 HP)
Hydraulic ram	7.5 kW (10 HP)

### EWS 45/160

Weight	approx. 9500 kg (20,900 lbs)
Stroke length	standard 1500 mm (59.1") optional 2500 mm (98.4")
Rotor diameter	450 mm (18")
Rotor knives	variable configuration 30 - 80
Rotor knives	useable on all 4 sides
Stator knife rows	2 (3 x 2 knife supports)
Stator knives	useable on 2 sides
Screen insert	according to the application
Drive	55 - 132 kW (75 - 180 HP)
Hydraulic ram	7.5 kW (10 HP)

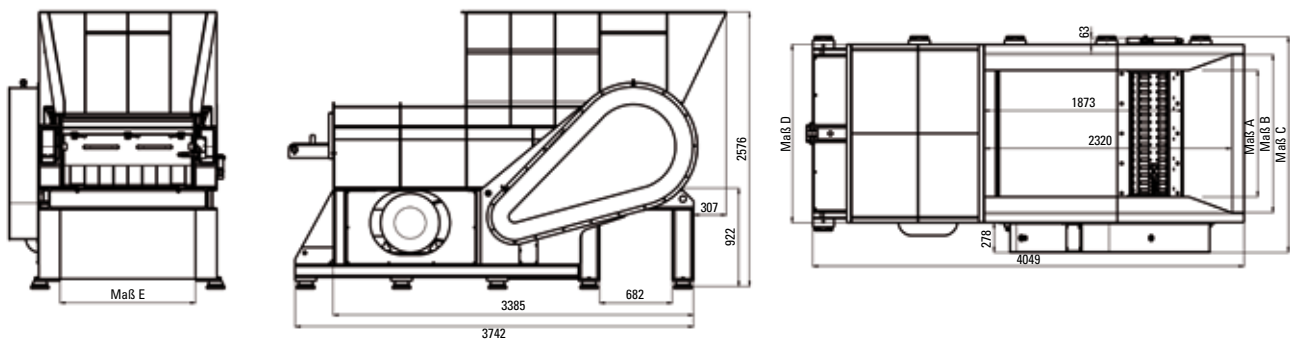

Fig. 6: EWS 45/120  
with standard stroke length

Dimensions					
Model	Size A	Size B	Size C	Size D	Size E
45/120	1187 mm	1483 mm	2023 mm	1672 mm	1272 mm
	(47")	(58.5")	(80")	(66")	(50")
45/160	1587 mm	1883 mm	2423 mm	2072 mm	1672 mm
	(62.5")	(74")	(95.5")	(81.5")	(66")



### Our product range

- Granulators
- Pulverizing Systems
- Shredders
- Hammer Mills
- HOG Shredders
- Guillotines
- Washing Systems
- Plastcompactors

### Herbold Meckesheim GmbH

Industriestr. 33  
D-74909 Meckesheim  
Postfach 1218  
D-74908 Meckesheim  
Tel.: + 49 (0) 6226 / 932-0  
Fax: + 49 (0) 6226 / 932-495  
E-Mail: [Herbold@Herbold.com](mailto:Herbold@Herbold.com)  
Internet: [www.Herbold.com](http://www.Herbold.com)

### Our US-Subsidiary:

**Herbold Meckesheim USA**  
**Resource Recycling Systems Inc.**  
333 George Washington Highway,  
USA-Smithfield,  
Rhode Island 02917  
Phone: + 1 401-232-3354  
Fax: + 1 401-232-5425  
[info@herboldusa.net](mailto:info@herboldusa.net)  
[www.herboldusa.net](http://www.herboldusa.net)